

JFW INDUSTRIES, INC.
 6731 N.E. 47TH PORTLAND, OREGON 97218 U.S.A.
 E-mail: jfwvalve@comcast.net
 Tel: 1 503 288 0673
 Fax: 1 503 288 1075

GENERAL TOLERANCE
 0.5-5 ±0.1
 6-30 ±0.2
 31-120 ±0.3
 121-1000 ±0.8

Surface Finish: Ra
 0.2 μm
 1.6 μm
 6.3 μm
 25 μm
 JIS

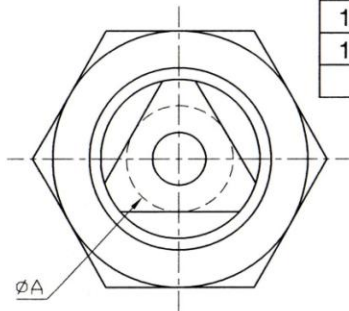
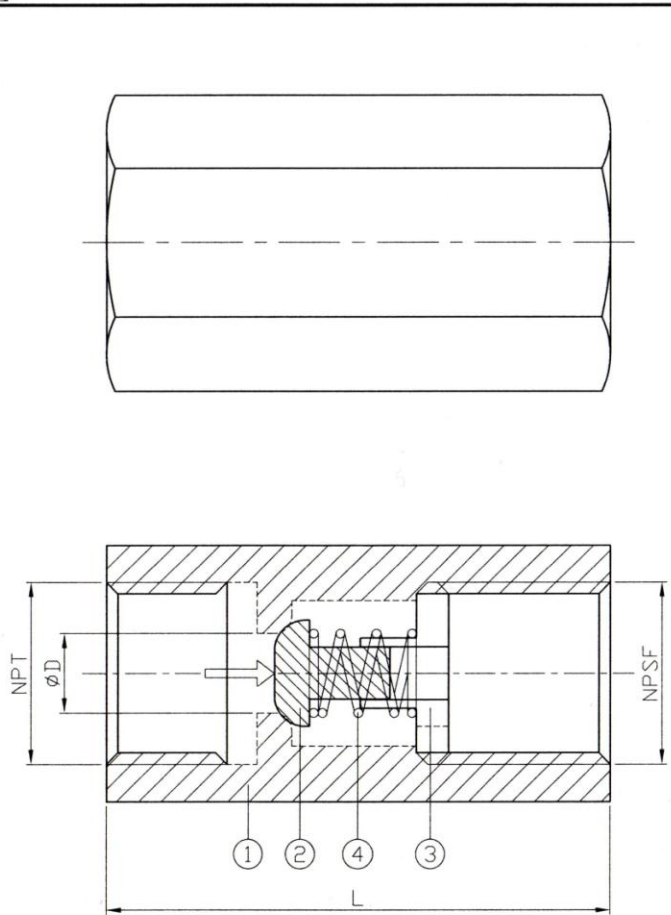

ITEM	PARTS	MATERIAL
1	BODY	SUS 316
2	DISC	
3	GUIDE CAP	ASTM A351-CF8M
4	SPRING	SUS 316

SIZE	D	A	L	Weight (lb)
1/4"	0.2	0.31	1.73	0.2
3/8"	0.28	0.43	1.89	0.3
1/2"	0.35	0.47	2.24	0.4
3/4"	0.49	0.63	2.76	1.1
1"	0.59	0.79	3.39	1.4
1-1/4"	0.79	0.94	3.7	2.4
1-1/2"	0.98	1.14	3.78	2.6
2"	1.26	1.5	4.49	4.5

unit:in

Opening Pressure STD In PSI

Size	↑	↓	→
1/4"	0.39	0.33	0.36
3/8"	0.39	0.33	0.36
1/2"	0.39	0.33	0.36
3/4"	0.39	0.33	0.36
1"	0.39	0.33	0.36
1-1/4"	0.42	0.33	0.38
1-1/2"	0.45	0.33	0.39
2"	0.45	0.33	0.39

*All size at 0.5PSI cracking

JFW INDUSTRIES, INC.

CHECK BY	DRAWING BY	DATE	SPECIFICATION	Spring Vertical Check Valve 2000 WOG
	<i>Sammy</i>	Feb.04.2016	MATERIAL	SUS 316
			PROCESS/Nr.	
			UNIT / SCALE	mm

△			
△			
△	Add weight	2/04/2016	Ray
Revise	Description	Date	Approve
DRAWING NO.		ILC-2M	- 16