

NPS	D	D1	D2	L	Weight (lb)
2"	4.06	2.01	2.52	2.36	4.4
2-1/2"	4.8	2.56	3.07	2.64	6.6
3"	5.31	3.15	3.7	2.87	8.8
4"	6.81	4.02	4.53	2.87	13.2
5"	7.68	5	5.31	3.39	17.6
6"	8.66	5.98	6.5	3.86	28.7
8"	10.91	7.99	8.46	5	55.1
10"	13.27	10	10.55	5.75	86
12"	16.02	12.01	12.36	7.13	119

unit:in

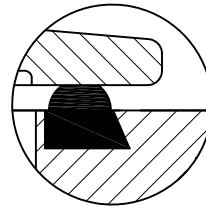

Seal face schematic:VITON seat

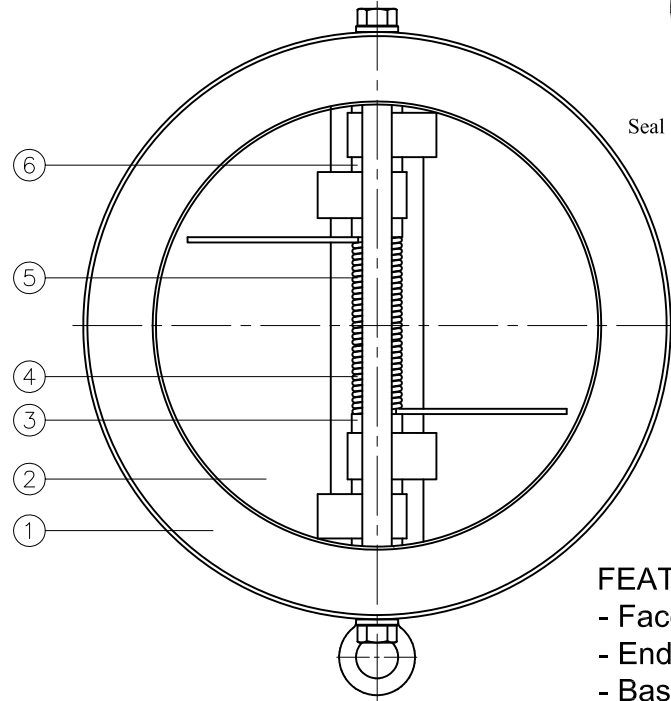

ITEM	PARTS	MATERIAL
1	BODY	ASTM A351-CF8M
2	DISC	
3	SPRING PLATE	2"~5" ASTM A182-F316
		6"~12" ASTM A276-316
4	SPRING	ASTM A182-F316
5	SHAFT	
6	BEARING	PTFE
7	LIFTING RING (≥6")	ASTM A29-1035
8	PLUG	ASTM A182-F316
9	GASKET	

SIZE	Cv (gallon/min)
2"	74
2-1/2"	128
3"	201
4"	338
5"	557
6"	878
8"	1675
10"	2726
12"	4301

FEATURE :

- Face to Face Dimension : API 594
- End Flange Dimension : ASME B16.5
- Basic Design : API 594
- Test Standard : API 598

△	Revise dimension,weight,drawing,material,add 2-1/2"&5" dimension,Cv,Remove DN dimension	08/15/2022	Ray
△	Add Cv	03/03/2016	Ray
△	Add weight	02/23/2016	Ray
△	Revised spring material	10/14/2015	Ray
△	Add 10" & 12" dimension	10/14/2015	Ray
Revise	Description	Date	Approve

E-mail: jfwvalve@comcast.net
Tel: 1 503 288 0673
Fax: 1 503 288 1075

JFW INDUSTRIES, INC.
6731 N.E. 47TH PORTLAND,
OREGON 97218 U.S.A.

JFW INDUSTRIES, INC.

CHECK BY	DRAWING BY	DATE	SPECIFICATION	Wafer Type Dual Plate Check Valve Class 150
	<i>Yuan</i>	Aug.15.2022	MATERIAL	CF8M
			PROCESS/Nr.	
			UNIT / SCALE	mm

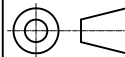

DRAWING NO.

WCV-150